

Creating a Neighborhood Plan: *Transportation Strategies*



TRANSPORTATION IMPROVEMENT EXAMPLES

Crosswalk Bumpout or Knockdown



Benefits

- Reduce roadway width curb to curb creating shorter crossing distances for pedestrians.
- Improve driver visibility of pedestrians.
- Slow vehicular traffic speeds.
- Allow for pedestrian amenities.

Concerns and considerations

- May require additional snow removal effort.
- Need careful design in coordination with street parking, bus stops and bike lanes.



Bumpout in West Palm Beach, FL

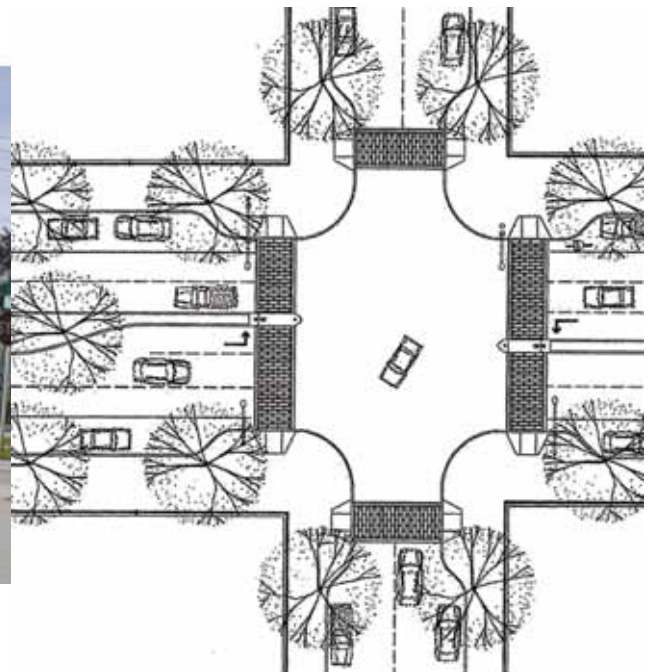

Additional Crosswalk Improvements

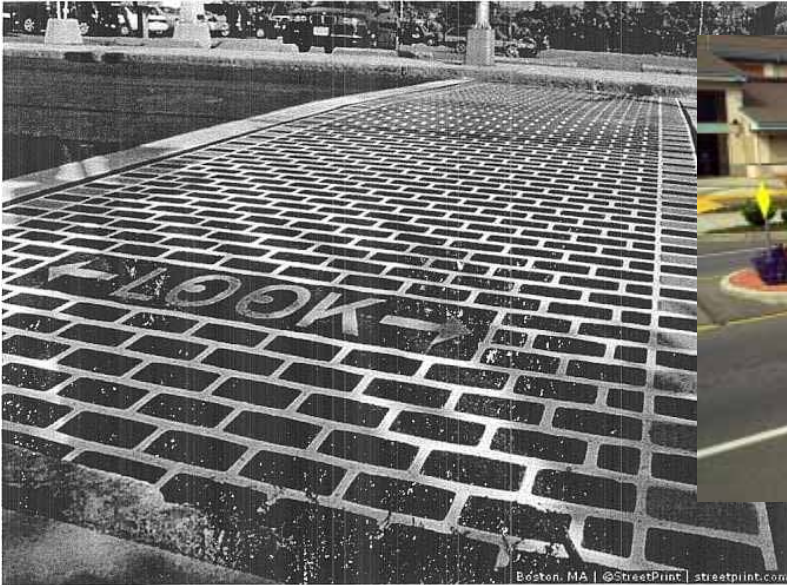

Textured crosswalk in Boston, MA



Textured and colored crosswalk in Oakland, CA



Crosswalk with color in Madison, WI

Benefits

- Improves driver visibility of pedestrians and bicyclists.
- Gives pedestrians a more distinguished space to walk among other modes.
- Enhances appearance of intersection.

Concerns and considerations

- May require more effort to maintain.
- Could be more costly to install than uncolored pavement.

Creating a Neighborhood Plan: Transportation Strategies



Traffic Circle: Kendall Avenue, Madison's Near Westside



Benefits

- Improve driver visibility of pedestrians and bicyclists.
- Motorists must think more carefully about how to maneuver through intersection.
- Slows traffic, particularly in uncontrolled intersections.
- Provides place for plantings.

Concerns and considerations

- More effort for snow removal and maneuvering of larger vehicles.
- Best used on lower volume residential streets where one vehicle is moving through the intersection at a time.

Roundabout



Benefits

- Traffic is forced to slow down in a roundabout, creating a safer intersection for vehicles, pedestrians and bicyclists.
- No red lights to run – roundabouts are designed to keep traffic flowing without requiring vehicles to stop, so the incentive for drivers to speed up to make it through a yellow or red light is removed.
- Add to urban aesthetic with elimination of overhead wires and signal poles.
- Can be a distinctive feature of a gateway into a neighborhood.
- Could include a rain garden for a cost-effective, low-impact way to infiltrate stormwater (plant height restrictions).

Concerns and considerations

- Provide directional signage to help drivers navigate through the roundabout, particularly in areas where drivers are unaccustomed to them.
- Need careful attention to design for pedestrian and bicycle safety.

Creating a Neighborhood Plan: *Transportation Strategies*



Pedestrian Refuge Island

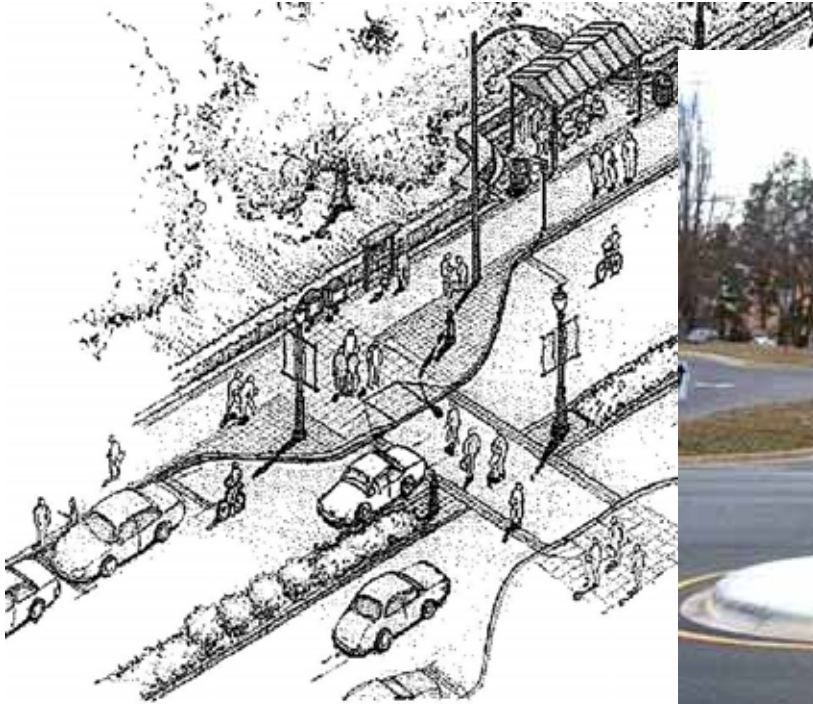

Benefits

- Provide pedestrians and bicyclists a refuge partway through crossing, often located mid-block.
- Require shorter pedestrian signal phases, thereby reducing traffic delays.
- Effective at unsignalized crossing of high-volume thoroughfares of four or more lanes, or high volumes of roadway traffic.
- Helpful where people walk more slowly such as near retirement communities, daycare centers, housing that accommodates people with disabilities, etc.

Concerns and considerations

- Could be more effort for snow removal.
- Learning curve for both pedestrians and drivers not accustomed to pedestrian refuges, especially unsignalized mid-block crossings.